

Typical Premier Specification

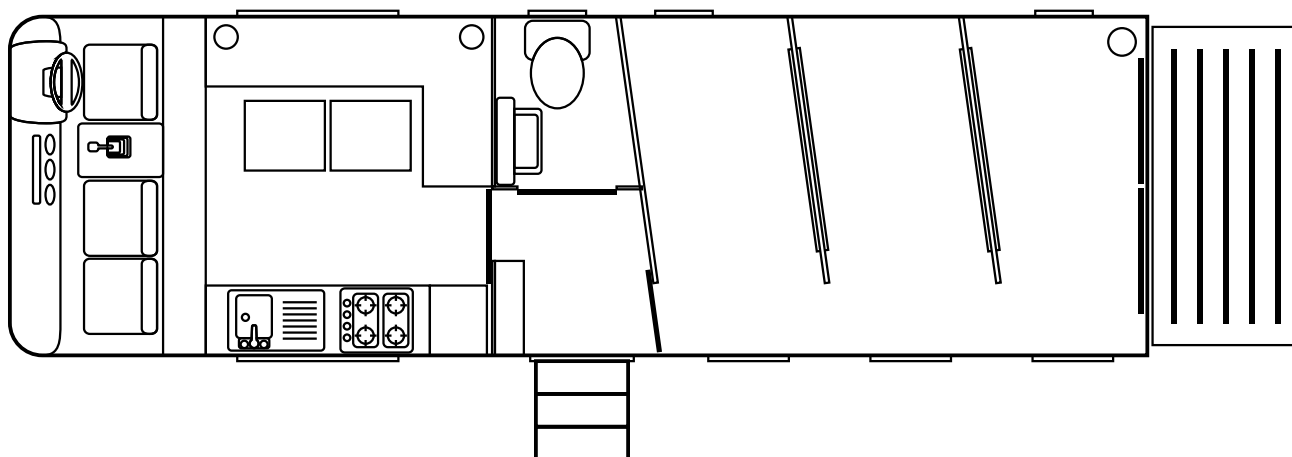

The **Premier** is typically built on a non-HGV 7.5-ton chassis with a 19' 6" (5.9m) container partitioned for 2 horses or 3 ponies with integral cab and luton above.

Standard features include:

Vestibule Area

- Accessed via a groom's door with integral fold down steps below.
- Fitted heavy-duty doormat.
- Umbrella and riding crop rack.
- Wardrobe with storage cupboards below.

Living area

- Sliding door from entrance vestibule.
- Large tinted side-sliding windows.
- Upholstered luton with cushion to sleep 2 adults.
- Upholstered seating with storage below.
- Slide out under-seat tray with additional cushions to convert into a double bed to sleep 2 adults.
- Dual pedestal tables (stored below seating).

Kitchen area

- Inset sink with flush glass top cover.
- Inset hob unit with flush glass top cover and oven/grill below (electronic ignition).
- Gas powered hot/cold water system with electric pump and 100 gallon tank.
- 3 way refrigerator powered by either DC electric/gas/AC mains as required.
- Wardrobe and additional cupboards under/over the kitchen area and also above the seating.
- Skylight / air ventilator.
- Additional subdued lighting over the kitchen area and seating.

Shower / Toilet

- Fold away hand basin with hot/cold water and wall cabinet/mirror.
- Shower with hot/cold water.
- Towel / soap holders.
- Cassette toilet with electric flush (cassette removed externally for easy cleaning).
- Cloakroom fittings.

Horse Area

- Sliding groom's door from entrance vestibule.
- Sliding tinted windows with removable grilles for cleaning.
- Tough fitted rubber flooring with drainage.
- Adjustable padded partitions with head guards.
- Substantial well balanced ramp with hardwood runners and rubberised anti-slip covering.
- Latching gates with reinforced aluminium tops.
- Rug rack.
- Skylight / air ventilator.
- Ramp spotlight.

Exterior

- Underfloor lockers.
- Gas bottle carrier designed for two propane cylinders (6kg).
- Battery holder.
- Hot/cold external water supply with hose attachments.
- AC mains hook-up point and integral battery charger for separate living area batteries.

G.Cooke Coachbuilders

41-43 Quakers Coppice, Crewe Gates Farm Industrial Estate, Crewe, Cheshire CW1 6FA.
Tel: 01270 588598 Fax: 01270 583787 email: info@cookecoachbuilders.com